

FRONT VIEW

TYPE B

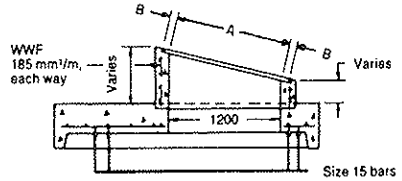

SECTION A-A

| SLOPE OF GRATING | DIMENSIONS | |
|------------------|------------|-----|
| | A | B |
| 2 : 1 | 1365 | 55 |
| 3 : 1 | 1285 | 95 |
| 4 : 1 | 1260 | 110 |
| 6 : 1 | 1240 | 55 |
| 8 : 1 | 1230 | 60 |
| 10 : 1 | 1225 | 60 |
| Horizontal | 1220 | 65 |

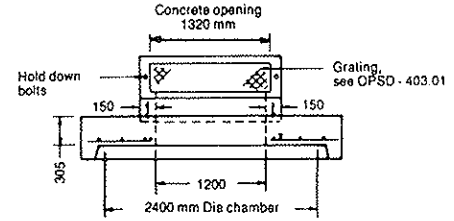

FRONT VIEW

TYPE A

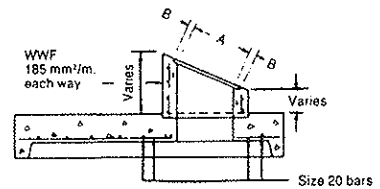

SECTION B-B

| SLOPE OF GRATING | DIMENSIONS | |
|------------------|------------|----|
| | A | B |
| 2 : 1 | 675 | 50 |
| 3 : 1 | 645 | 65 |
| 4 : 1 | 625 | 75 |

- NOTES:**
- A All reinforcing steel shall have 25 mm min cover.
 - B Weep holes, where required, shall be placed so that the bottom of the weeper on the inside and the top of the weeper on the outside are level.
 - C All dimensions are in millimetres unless otherwise specified.



CON CAST PIPE
 R.R. #3, Guelph, Ontario N1H 6H9
 Tel: 1-800-668-PIPE (7473)

CON CAST PIPE | No. 706.03

600 x 1200 mm
PRECAST CONCRETE
DITCH INLET MAINTENANCE HOLES
WITH 2400 mm Dia. FLAT CAP