

Part ID	Pipe ID	OD	H	D	T	W	Anchor Size	A	B	B15-1	B15-2	X15-3	Mass (kg)
HA03001-1	305	546.1	1495	600	425	2834	4TON x 240 (9 1/2")	709	715	2734	1395		3648
HA03751-1	381	635	1583	637.5	432	3100	4TON x 240 (9 1/2")	775	753	3000	1483		4237
HA04501-1	457	723.9	1672	675	439	3367	4TON x 240 (9 1/2")	842	791	3267	1572		4871
HA05251-1	533	812.8	1761	712.5	447	3634	4TON x 240 (9 1/2")	909	828	3534	1661		5557
HA06001-1	610	901.7	1850	750	454	3900	4TON x 240 (9 1/2")	975	865	3800	1750	1110	6282
HA06751-1	686	990.6	1939	787.5	462	4137	4TON x 240 (9 1/2")	1034	902	4037	1839	1186	7010
HA07501-1	762	1079.5	2028	825	469	4434	8TON x 210 (8 1/4")	1109	939	4334	1928	1262	7887
HA08251-1	838	1168.4	2117	862.5	476	4700	8TON x 210 (8 1/4")	1175	976	4600	2017	1338	8757

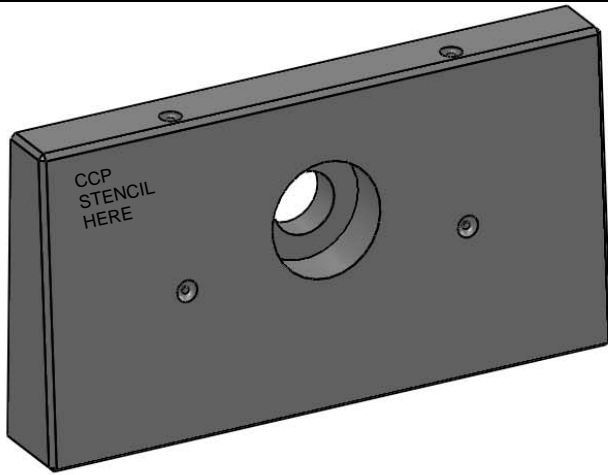

**CCP STENCILING REQUIREMENTS**  
 CONCAST LOGO  
 (SIZE) OPS HEADWALL  
 DATE OF MANUFACTURE

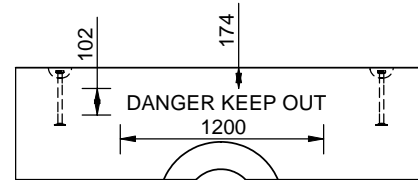

**EMBOSSING DETAIL ON VERTICAL FACE**

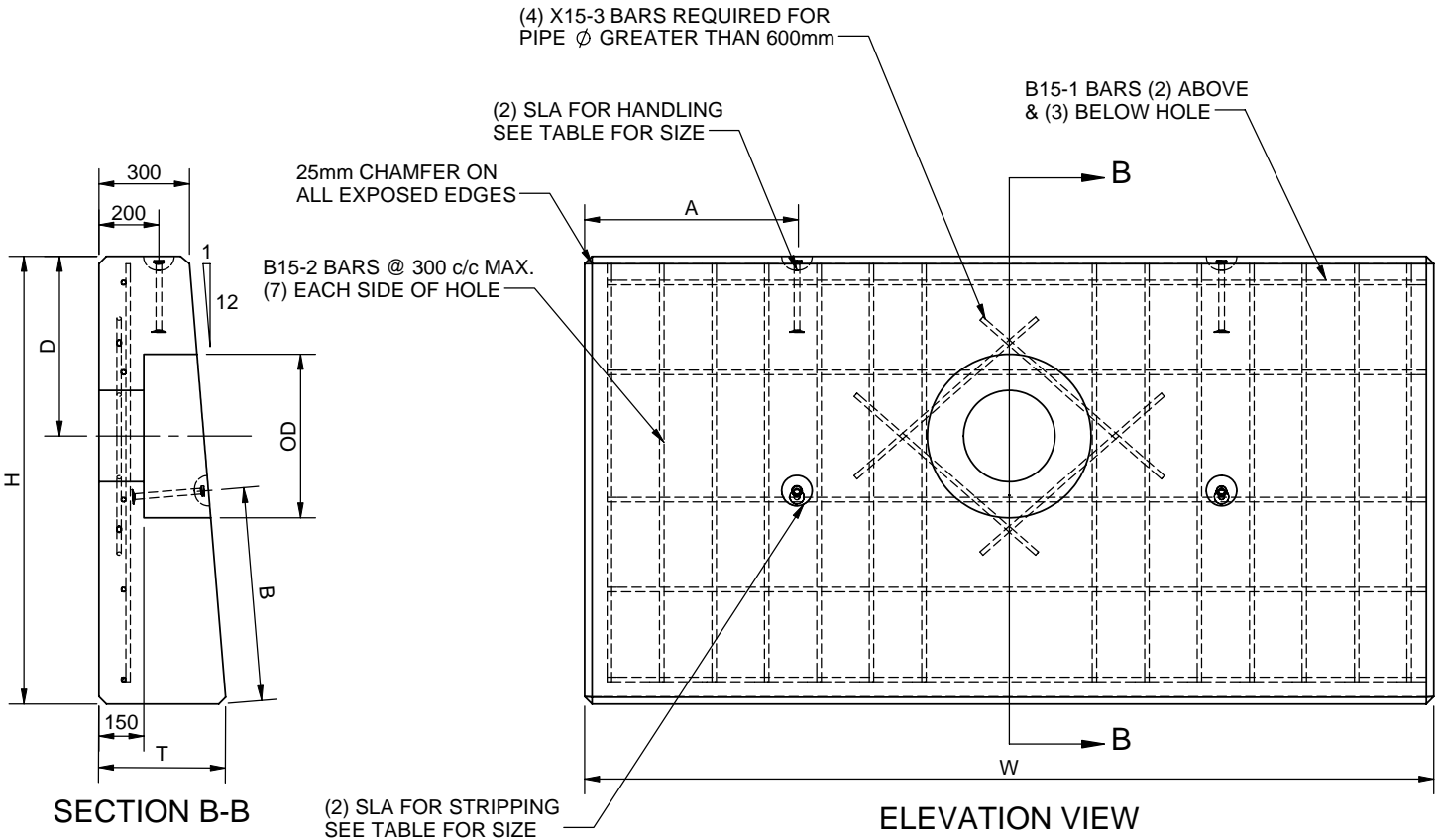

ALL DIMENSIONS ARE IN mm  
 DRAWINGS ARE NOT TO SCALE  
 WWF SHEETS TO CSA G.30.5 AND CSA G.30.15  
 REINFORCING TO CSA G.30.18 GRADE 400W  
 PRECAST MFG. TO OPSS 1821 (APRIL / 2004)

MIN. CONC STRENGTH 35 MPa  
 CLEAR COVER = 75 mm ± 20 mm  
 TOLERANCES TO CSA A23.4-05 : 12.2  
 APPROX. MASS kg  
 STRIP CONC. STRENGTH 20 MPa  
 AIR ENTRAINMENT 5% TO 8%

**CON CAST PIPE STANDARD DRAWING**

STD. OPSD 804.030 NOV 2006 REV1 PART HAXXXX2-1

TITLE  
**CONCRETE OPS HEADWALL FOR PIPE LESS THAN 900mm Ø (HAXXXX2-1 WITH GRATE)**

REV.	DESCRIPTION	ENG.	DATE

DRAWN BY	CHECKED BY	DATE	FILE	PAGE
AEM	SW	4/9/2010	Headwall	1