

AS POUR VIEW

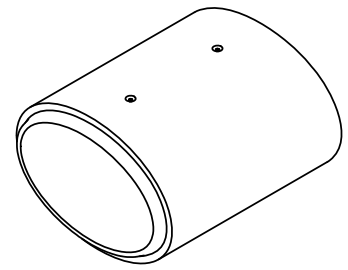

ISOMETRIC VIEW

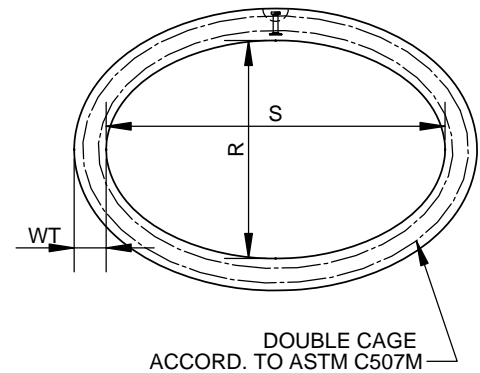

TYPICAL SECTION A

EQV. SIZE	S	R	WT	OD	D	A (°)
900	1145	735	115	1375	42.9	1.8
1050	1345	865	127	1599	60.3	2.2
1200	1525	965	140	1805	68.3	2.2
1350	1725	1090	152	2029	69.9	2.0
1500	1930	1220	165	2260	77.8	2.0
1800	2110	1345	178	2466	104.8	2.3

NOTES:

1. TRIM INTERMEDIATE LONGITUDINAL WIRES ACCORDING TO LONG AND SHORT SIDE
2. DROP LIMIT BASED ON INFORMATION PROVIDED BY HAWKEYE

ALL DIMENSIONS ARE IN mm
DRAWINGS ARE NOT TO SCALE
STEEL DESIGN ACCORDING TO ASTM C507M
REFER TO ELLIPTICAL PIPE DESIGN FOR DETAIL

MIN. CONC STRENGTH 35 MPa
CLEAR COVER = 30 mm ± 5 mm
TOLERANCES TO ASTM C507M

CON CAST PIPE (CCP) STANDARD DRAWING

STD. ASTM C507M

DOC ID ERXXXX

TITLE
**RADIUS HORIZONTAL ELLIPTICAL PIPE
900 - 1800 mm EQV. SIZE
DROP LIMIT
DRY CAST**

2			
1			
0	INITIAL RELEASE	SW	12MAY16
REV.	DESCRIPTION	ENG.	DATE

DRAWN BY SW	CHECKED BY SW	DATE 12MAY16	FILE HEP RADIUS.SLDDRW	PAGE 1 OF 1
----------------	------------------	-----------------	---------------------------	----------------