

**POUR VIEW
(RADIUS LEFT)**

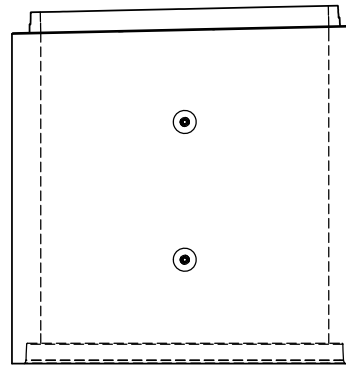

**POUR VIEW
(RADIUS RIGHT)**

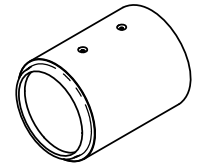

**ISOMETRIC VIEW
(AS INSTALLED)**

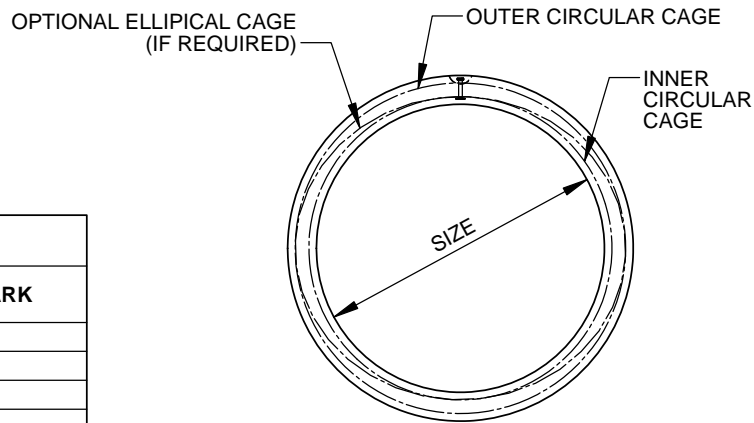

SECTION C

DROP LIMIT (MAX D)			
SIZE NOMINAL	D	A°	REMARK
1200	41	1.58	
1350	46	1.58	
1500	68	2.13	
1650	70	2.00	
1800	51	1.33	MANHOLE FORM
1800	76	2.00	PIPE FORM
1950	83	2.00	
2100	87	2.00	
2250	94	2.00	
2400	102	2.00	
3000	110	1.75	

NOTES:

1. TRIM INTERMEDIATE LONGITUDINAL WIRES ACCORDING TO LONG AND SHORT SIDES
2. DROP LIMIT BASED ON INFORMATION PROVIDED BY HAWKEYE

ENGINEER STAMP (IF REQUIRED)

ALL DIMENSIONS ARE IN mm
DRAWINGS ARE NOT TO SCALE
ALL VIEW AS POURED UNLESS SPECIFIED
CONFORM TO CSA 257.2
READ THIS DRAWING IN CONJUNCTION WITH
PIPE CAGE DESIGN DRAWING
ALL RADIUS PIPE ARE BUILT TO ORDER.
PIPE DIM REF. TO PAXXXX4

MIN. CONC STRENGTH = BASED ON
CLASS
TOLERANCES TO CSA A257.2
TYPE HSe CEMENT

CON CAST PIPE (CCP) STANDARD DRAWING

STD. CSA 257.2

DOC ID PRXXXX

TITLE

**RADIUS PIPE
DROP LIMIT
(DRY CAST)**

1	INITIAL RELEASE	SM	12MAY16
REV.	DESCRIPTION	ENG.	DATE

DRAWN BY SM	CHECKED BY SW	DATE 19/OCT/15	FILE PipeRadius	PAGE 1 OF 1
----------------	------------------	-------------------	--------------------	----------------