

**POUR VIEW  
(RADIUS LEFT)**

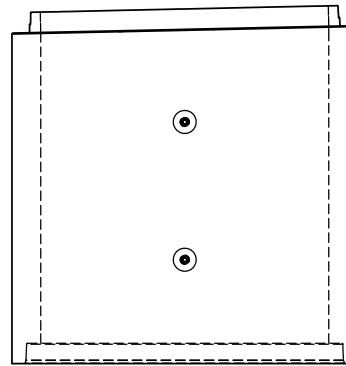

**POUR VIEW  
(RADIUS RIGHT)**

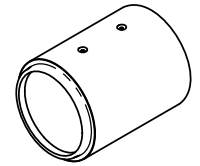

**ISOMETRIC VIEW  
(AS INSTALLED)**

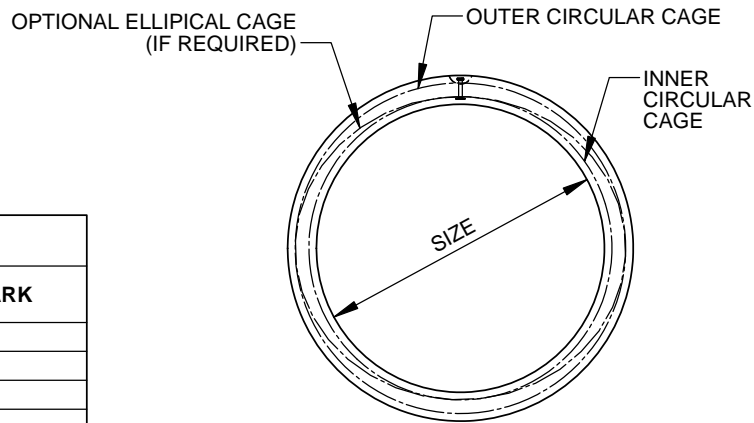

**SECTION C**

| DROP LIMIT (MAX D) |     |      |              |
|--------------------|-----|------|--------------|
| SIZE NOMINAL       | D   | A°   | REMARK       |
| 1200               | 41  | 1.58 |              |
| 1350               | 46  | 1.58 |              |
| 1500               | 68  | 2.13 |              |
| 1650               | 70  | 2.00 |              |
| 1800               | 51  | 1.33 | MANHOLE FORM |
| 1800               | 76  | 2.00 | PIPE FORM    |
| 1950               | 83  | 2.00 |              |
| 2100               | 87  | 2.00 |              |
| 2250               | 94  | 2.00 |              |
| 2400               | 102 | 2.00 |              |
| 3000               | 110 | 1.75 |              |

**NOTES:**

1. TRIM INTERMEDIATE LONGITUDINAL WIRES ACCORDING TO LONG AND SHORT SIDES
2. DROP LIMIT BASED ON INFORMATION PROVIDED BY HAWKEYE

ENGINEER STAMP (IF REQUIRED)

ALL DIMENSIONS ARE IN mm  
DRAWINGS ARE NOT TO SCALE  
ALL VIEW AS POURED UNLESS SPECIFIED  
CONFORM TO CSA 257.2  
READ THIS DRAWING IN CONJUNCTION WITH  
PIPE CAGE DESIGN DRAWING  
ALL RADIUS PIPE ARE BUILT TO ORDER.  
PIPE DIM REF. TO PAXXXXX4

MIN. CONC STRENGTH = BASED ON  
CLASS  
TOLERANCES TO CSA A257.2  
TYPE H<sub>se</sub> CEMENT

**CON CAST PIPE (CCP) STANDARD DRAWING**

STD. CSA 257.2

DOC ID PRXXXX

TITLE

**RADIUS PIPE  
DROP LIMIT  
(DRY CAST)**

|      |                 |      |         |
|------|-----------------|------|---------|
| 1    | INITIAL RELEASE | SM   | 12MAY16 |
| REV. | DESCRIPTION     | ENG. | DATE    |

|                |                  |                   |                    |                |
|----------------|------------------|-------------------|--------------------|----------------|
| DRAWN BY<br>SM | CHECKED BY<br>SW | DATE<br>19/OCT/15 | FILE<br>PipeRadius | PAGE<br>1 OF 1 |
|----------------|------------------|-------------------|--------------------|----------------|